

FILE No. I:\LOT2006 Projects\06-413\_RIVERS EDGE\Map3\_3\_Engineered Design\3\_Public Drawings\City of Brownsville\06-413\_Plan and Profile-Storm1-Storm3] 11/19/07 15:24 - stave

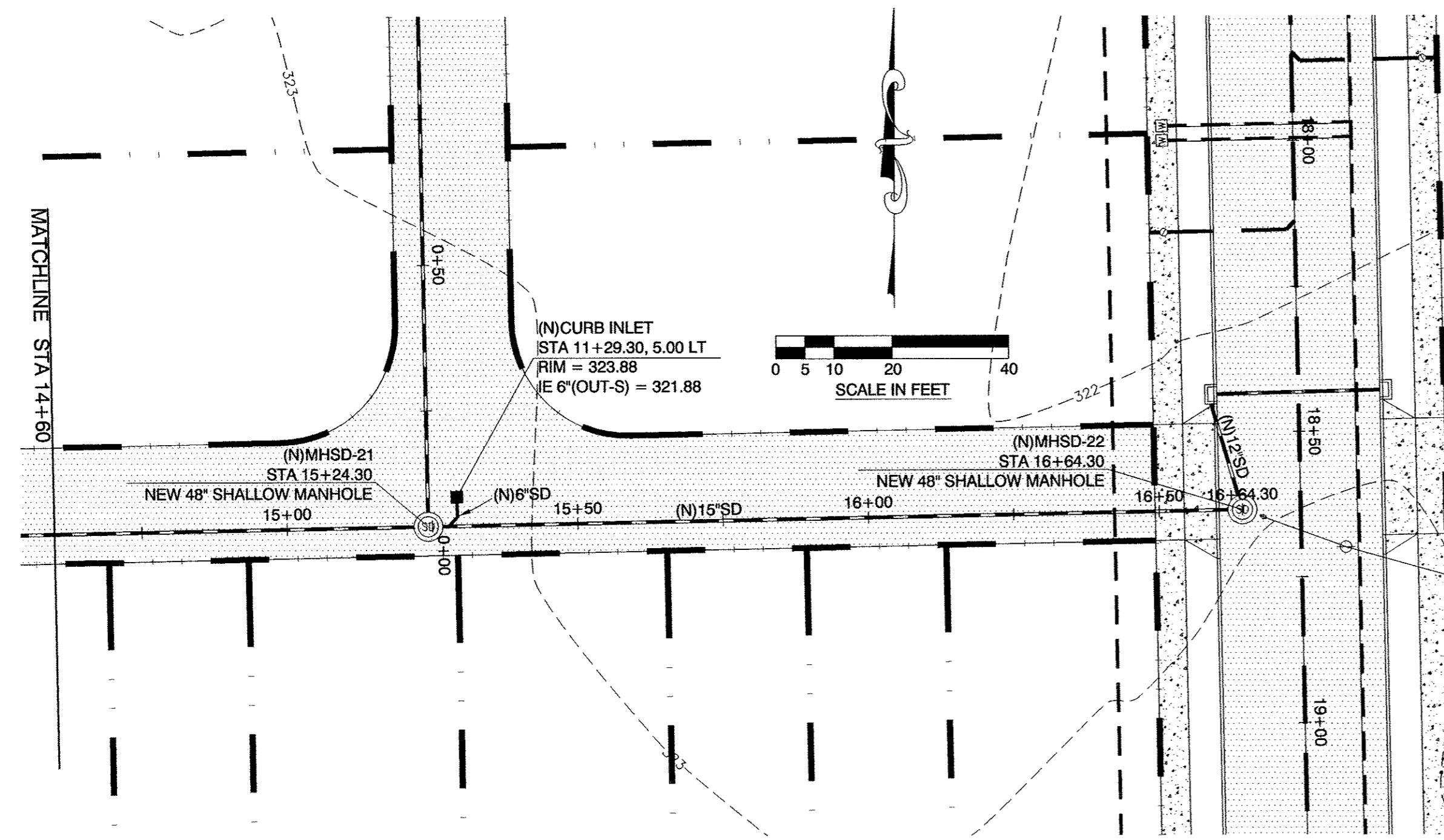

PLAN - OFFSITE STORM NO.1  
SCALE: 1" = 20'

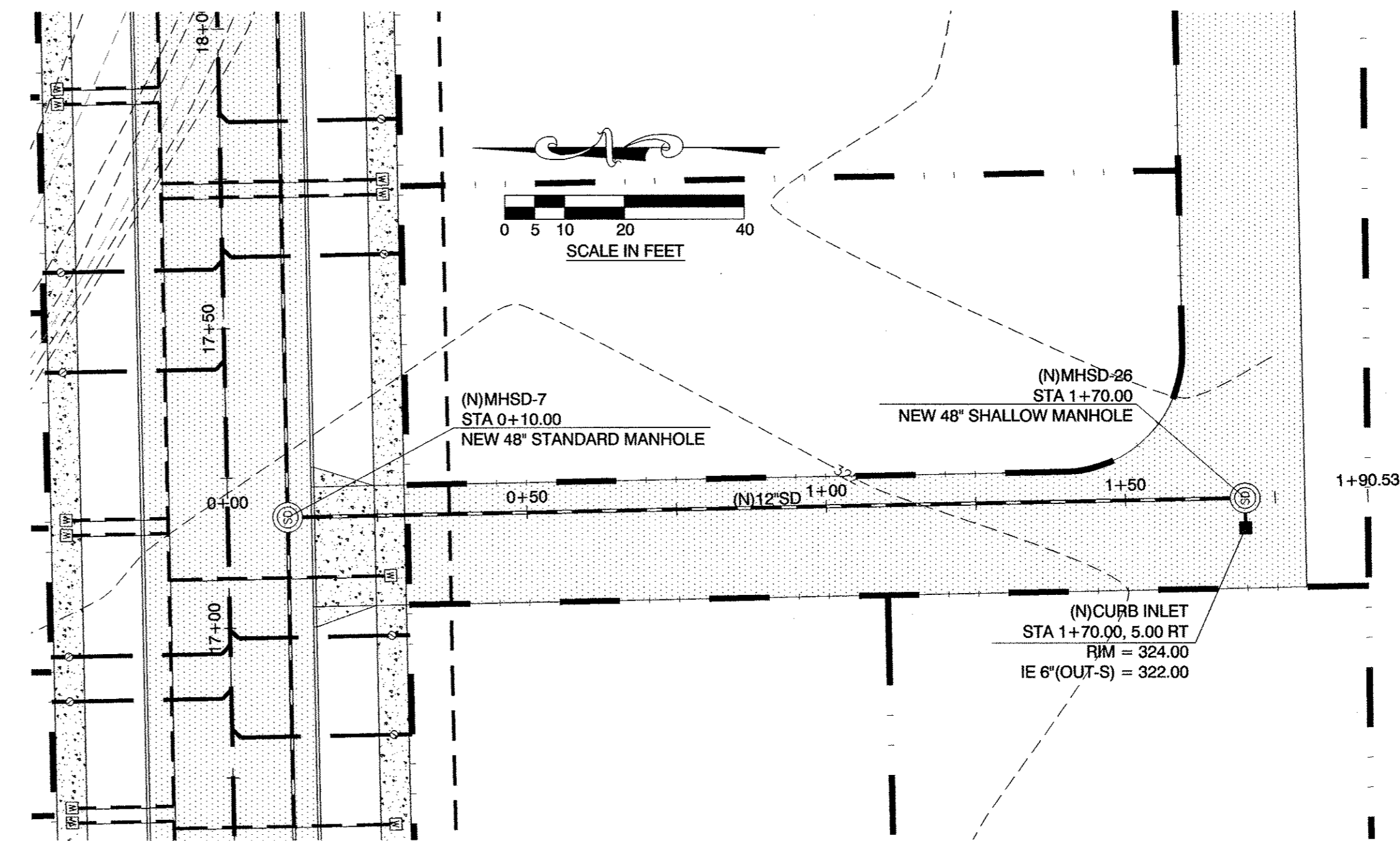

PLAN - OFFSITE STORM NO.3  
SCALE: 1" = 20'

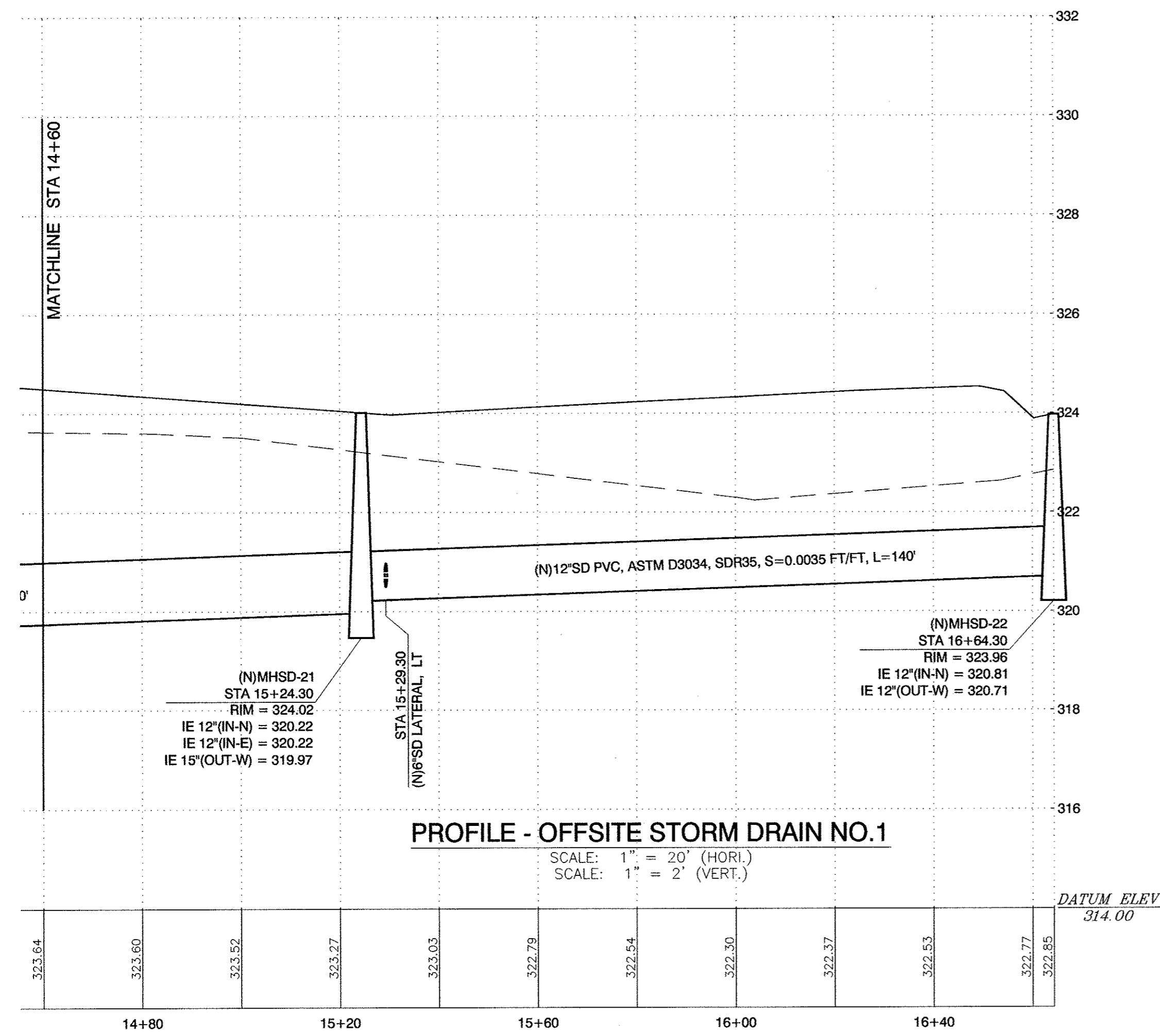

PROFILE - OFFSITE STORM DRAIN NO.1  
SCALE: 1" = 20' (HORI.)  
SCALE: 1" = 2' (VERT.)

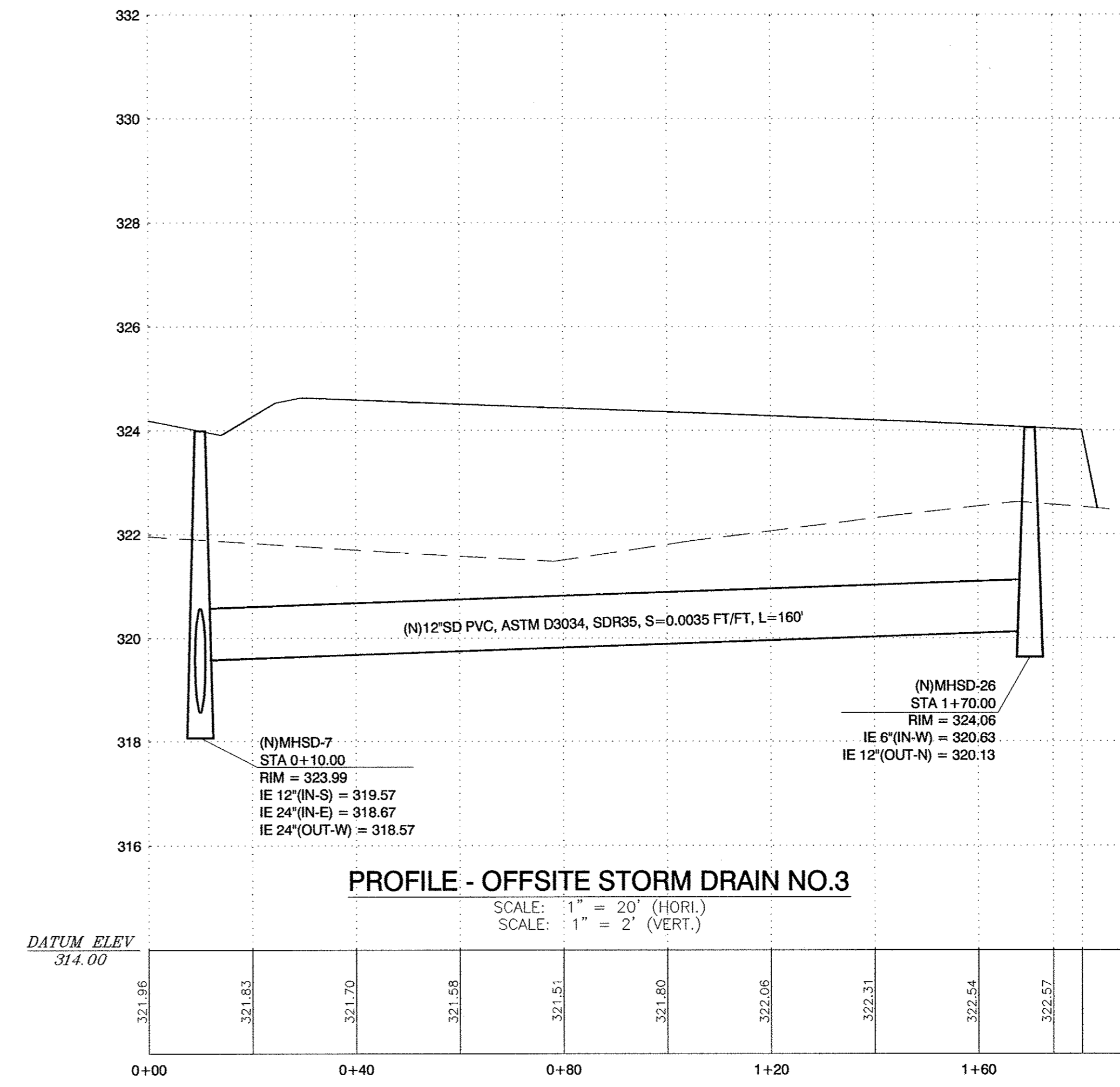

PROFILE - OFFSITE STORM DRAIN NO.3  
SCALE: 1" = 20' (HORI.)  
SCALE: 1" = 2' (VERT.)

No.	REVISION:	DATE:

**DEVCO**  
engineering inc.  
245 NE CONIFER, P.O. BOX 1211  
CORVALLIS, OR 97339  
WWW.DEVCOENGINEERING.COM

© COPYRIGHT 2004  
DEVCO ENGINEERING, INC.  
ALL RIGHTS RESERVED.

PROJECT: RIVER'S EDGE SUBDIVISION  
PROJECT LOCATION: BROWNSVILLE, OREGON  
CLIENT: DEPOT AVENUE, LLC

SHEET TITLE:  
OFFSITE STORM NO. 1  
PLAN AND PROFILE  
STA 14+60 TO END  
OFFSITE STORM NO. 3  
PLAN AND PROFILE  
STA 0+00 TO END

JOB NO. 06-413  
ISSUED: -  
DRAWN BY: DEVCO  
DRAWING: **C2.23**  
# OF SHEETS IN SET: X