

# MOUNTAINGATE SUBDIVISION

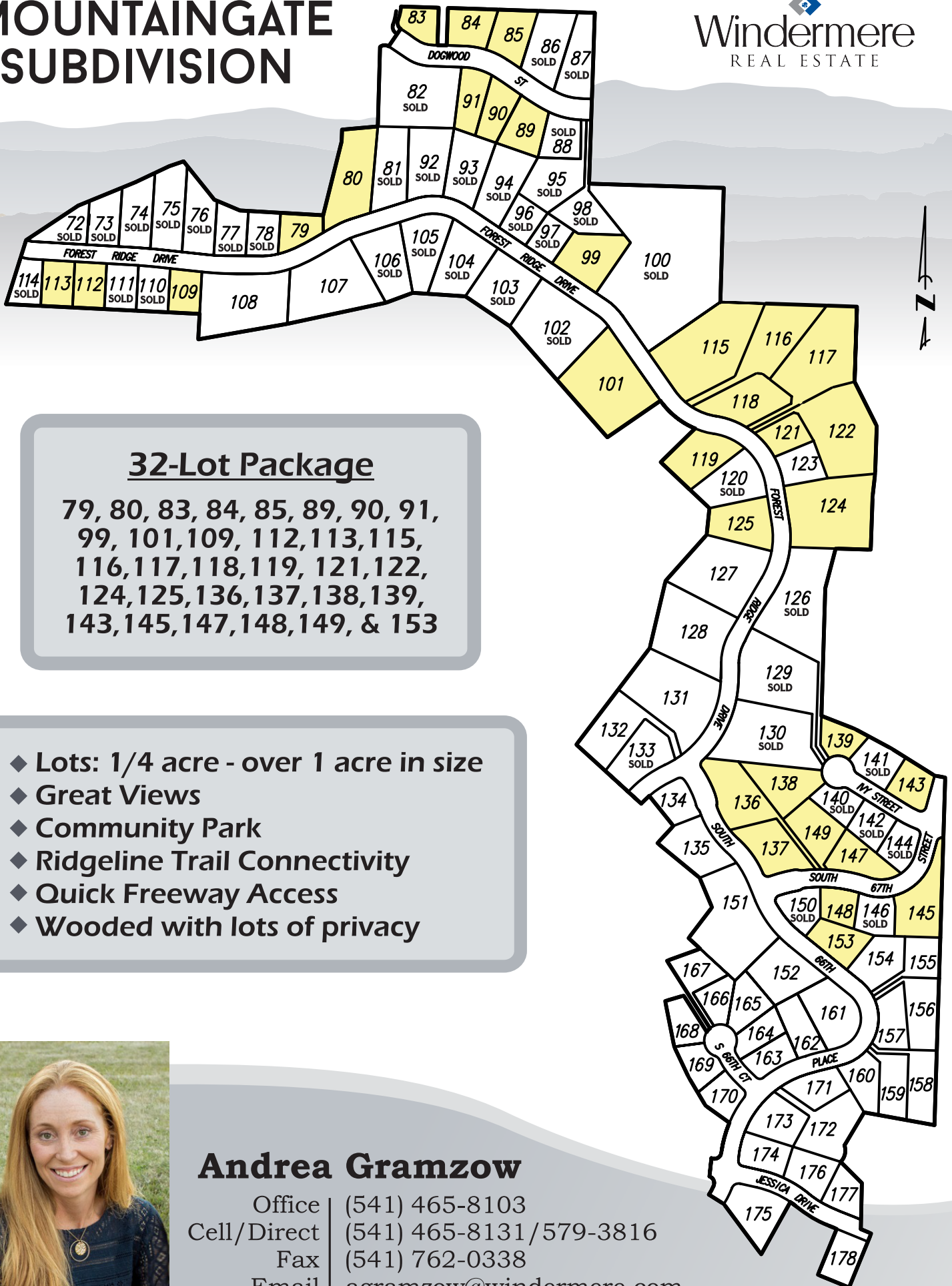

**32-Lot Package**  
 79, 80, 83, 84, 85, 89, 90, 91,  
 99, 101, 109, 112, 113, 115,  
 116, 117, 118, 119, 121, 122,  
 124, 125, 136, 137, 138, 139,  
 143, 145, 147, 148, 149, & 153

- ◆ Lots: 1/4 acre - over 1 acre in size
- ◆ Great Views
- ◆ Community Park
- ◆ Ridgeline Trail Connectivity
- ◆ Quick Freeway Access
- ◆ Wooded with lots of privacy



## Andrea Gramzow

Office | (541) 465-8103  
 Cell/Direct | (541) 465-8131 / 579-3816  
 Fax | (541) 762-0338  
 Email | [agramzow@windermere.com](mailto:agramzow@windermere.com)  
 WebSite | [andreamgramzow.com](http://andreamgramzow.com)